

ANAEROBIC DIGESTION AND COMPOSTING PLANT OF THE VALLÈS ORIENTAL WASTE TREATMENT CENTRE



Consorti
per a la
Gestió dels Residus
del Vallès
Oriental

Vanessa Abad Cuñado
Waste Treatment Operation Manager
9th May of 2018

□ GENERAL DATA:

- **Treatment Capacity (AA):** 51.184 t/year
- **Biogas production:** 4.200.000 m³/year
- **Electricity production:** 7,8 GWh/year
- **Compost production:** 5.000 t/year
- **Air treatment:** 100.000 Nm³/h
- **Waste water treatment:** Permission

RESULTS OF 2017



OFMSW
50.000T/year



**Electricity
generation**
7,3GWh/year



COMPOST
5.500T/year



**Equivalent
consumption.**
**7.000
citizens/year**



Saving 2.700 T CO₂/year

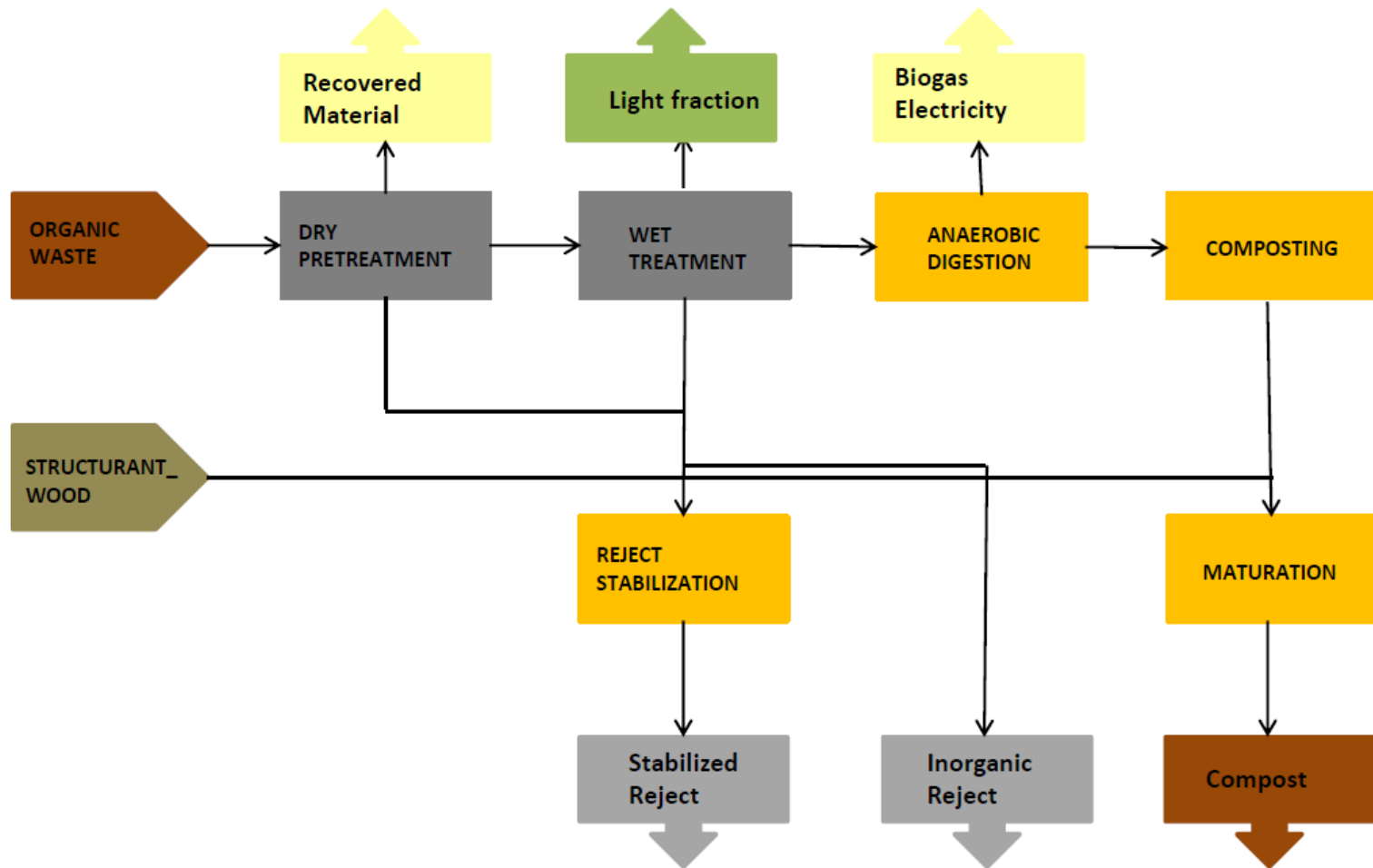

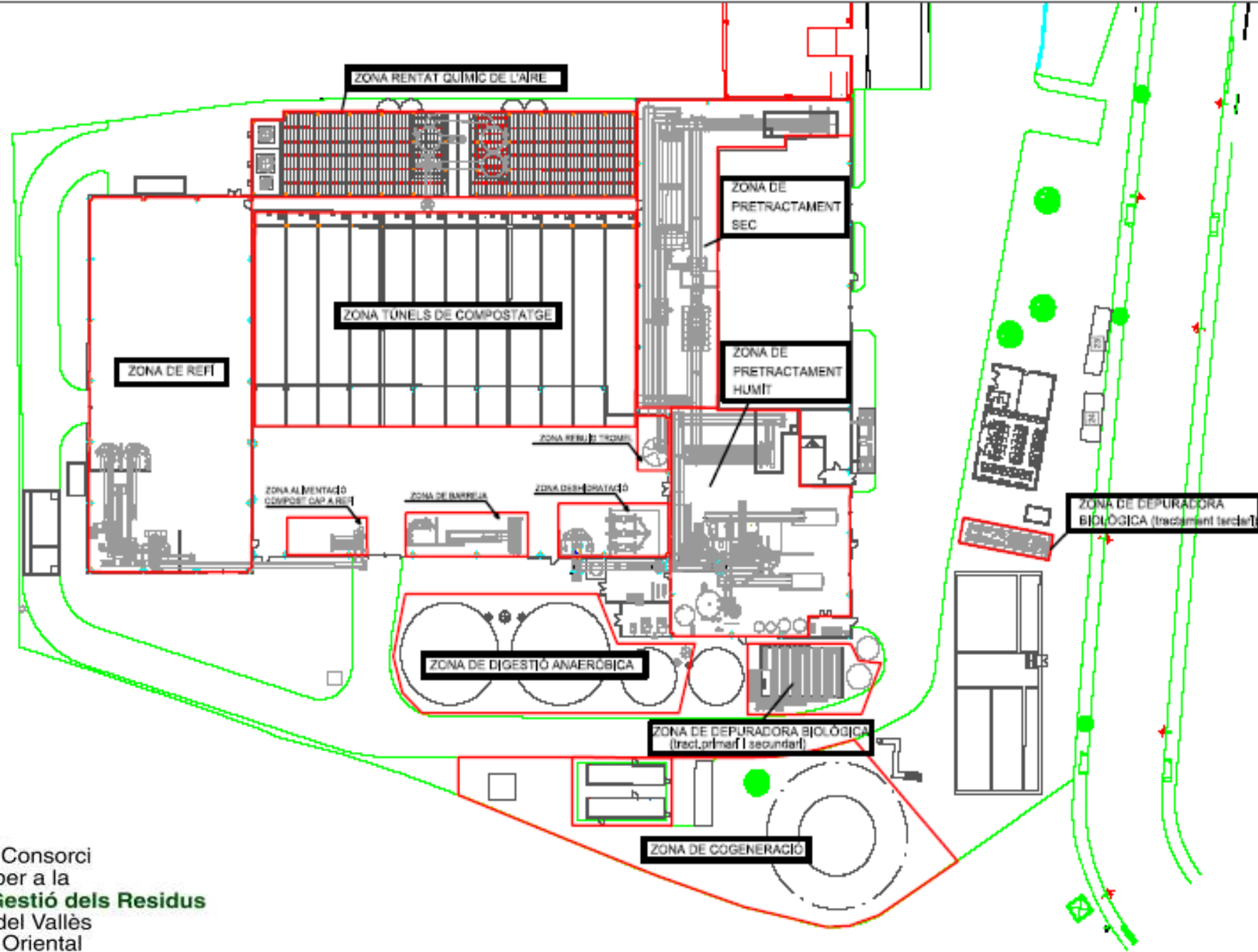



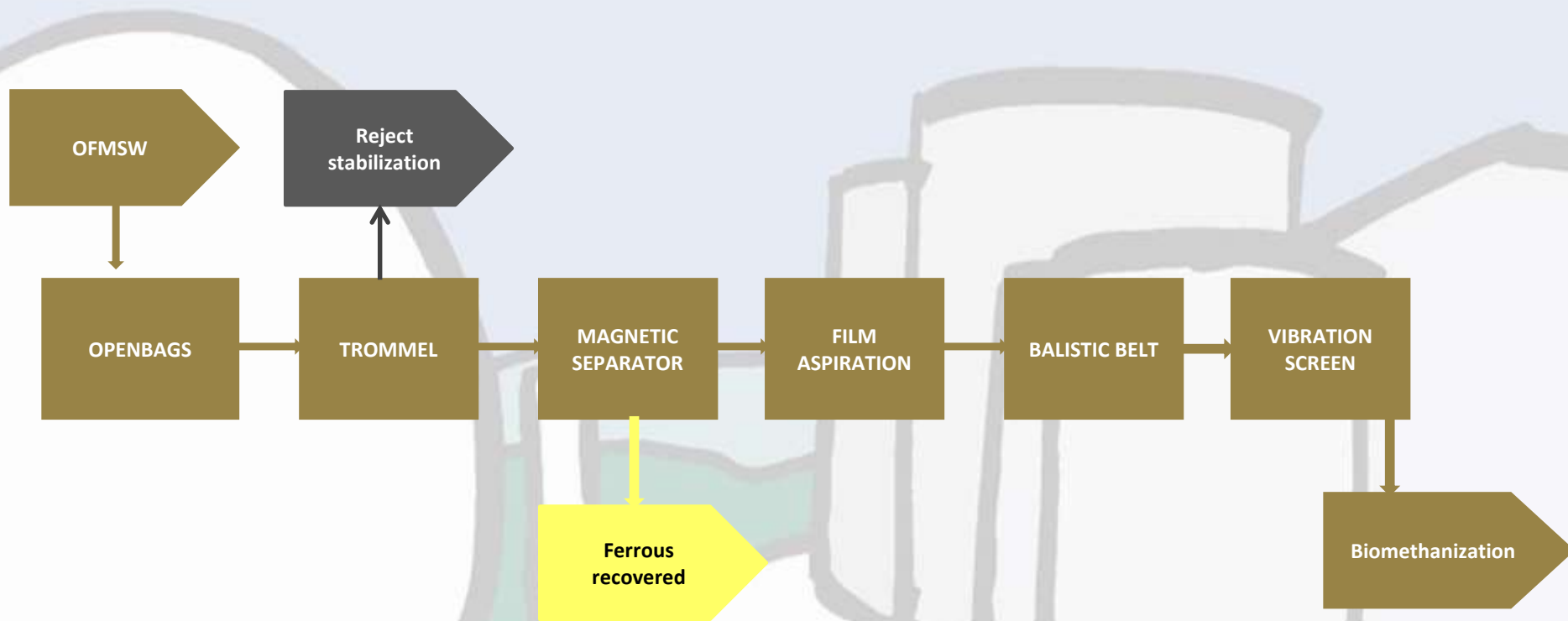



WET PRETREATMENT





LIGHT FRACTION



INERT REJECT





COMPOSTING PROCESS







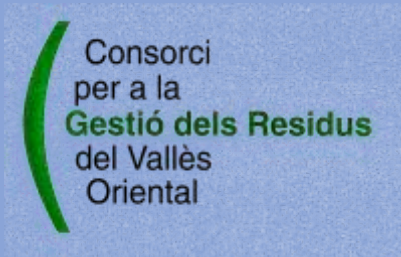

*Thank you very much for your
attention*

Camí Ral s/n – 08401 – Granollers – Tel. 938708579 Fax 938601669
www.cresidusvo.cat – cresidusvo@cresidusvo.cat